

1000A – 1600A INTELLIGENT LOAD TRANSFER PANELS

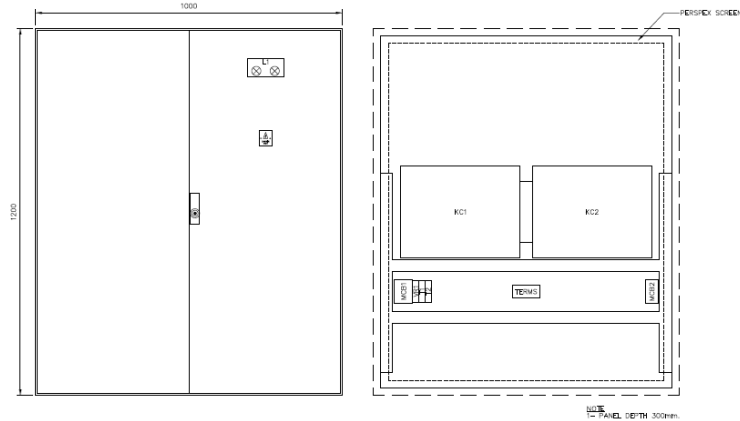

SPECIFICATION

Enclosure

Single Door

IP65 complying with EN50298:EN60529

Type 12, 4, 4X complying with UL508A; UL50

Impact resistance IK10 complying with EN500298; EN50102

Double Door

IP55 complying with EN50298; EN60529

Type 12, 4, 4X complying with UL508A; UL50

Impact resistance IK10 complying with EN500298; EN50102

Switches

40 & 63A

Conformity IEC 60947-3, EN 60947-3

125A to 1600A

Conformity IEC 60947-3, EN 60947-3, VDE 0600-107 (1992), NBN EN 60947-3,

BS EN 60947-3

Contactors

Conformity IEC/EN 60947-1

Approvals - IEC 158-1; VDE 0660; BS 5452; UL; CSA

Controller

Modular (6 modules) din rail mounting

Conformity

IEC 61010-1, IEC 61000-4-2, IEC61000-4-3, IEC 61000-4-4, IEC 61000-4-4,

IEC 61000-4-5, IEC 61000-4-6, IEC 61000-4-8, IEC 61000-4-11, IEC 60068-2-6, IEC60068-2-11, IEC

60068-2-30

Control Relays

Conforms to CE low voltage directive
 Approvals - UL, VDE, CSA

Terminals

Din Rail mounting
 EN 60947-7-1, DIN VDE 0611 T1, UL, CSA, KEMA, ATEX, FM, SEV, GL



<u>RATING</u>	<u>SIZE (HXWXD)</u>	<u>CABLING MM2 (max)</u>
1000A	1000 x 1200 x 300	60 x 5 bar

LAYOUT	
Wall Mounted	Floor Mounted